

PROVIDING SAFETY

WE PROTECT YOUR
most valuable asset
YOUR WORKFORCE



T +31 (0)10 822 44 00
www.usp-safety.com



SAFETY FENCE

Product overview

Flexible safety enclosures

Design oriented, robust and easily expandable aluminium profile technique



Special, quickly removable fields reduce maintenance times with maximum accesses of once or twice a month.



Openings can be created quickly and easily in any location. The layout of the fence is flexible.



The 'SSP-Fast-Connect-Technology' allows an easy and quick connection of the individual aluminium profiles. Thus, drilling and thread cutting is no longer necessary.



Panel types can be individually combined



EN ISO
14120:2015



The combination of floor attachment bracket and aluminum profile easily compensates for any unevenness.



The 'SSP grid fixation' ensures a solid connection between the profile and the filling. It increases the total stability of your safety enclosure.



Easy and individual assembly of the attachment components at any height or position thanks to the aluminum slot system.



SSP slot nuts align themselves into the notch when opened. Existing connections can be loosened easily.

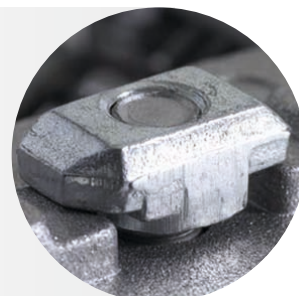

Modular aluminium safety fence

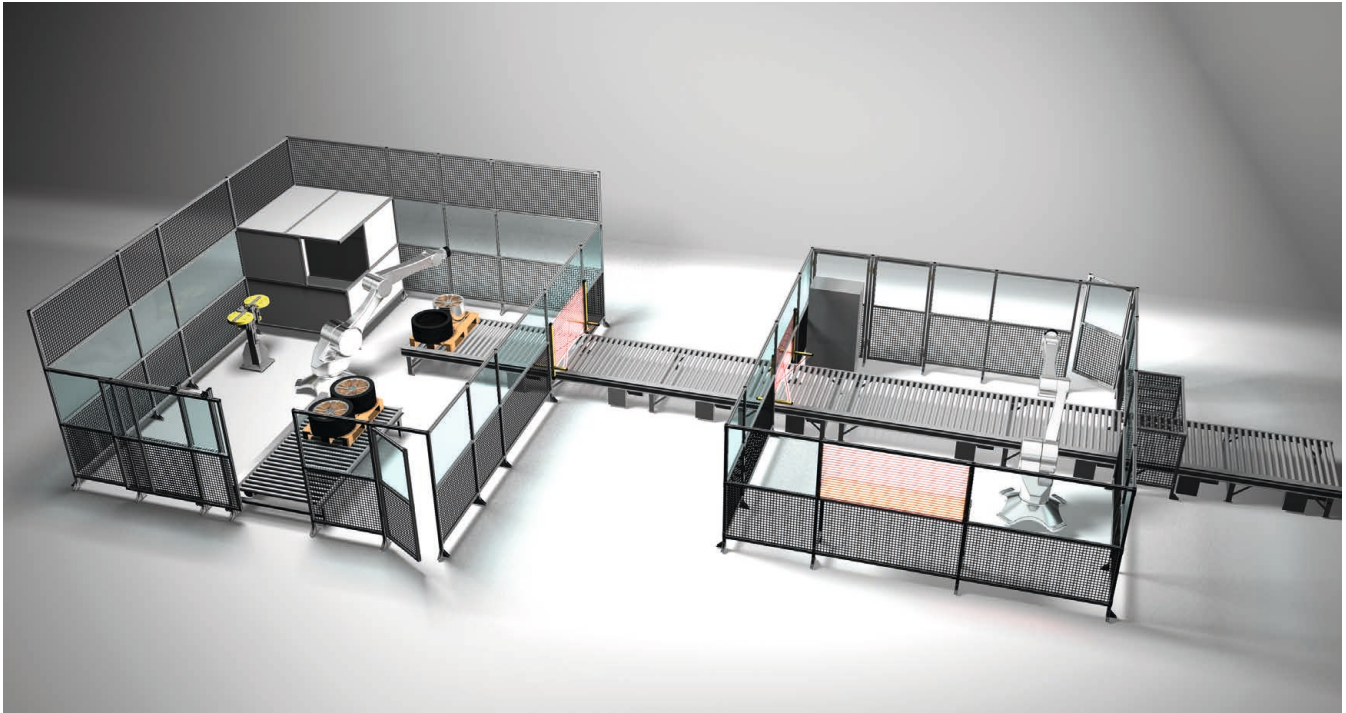

An off-the-shelf solution does not always fit; flexibility makes the difference!

For this reason, our company focused on a modular fence system made of aluminum. Thus, we are able to use standard modules that can be adjusted individually according to your requirements as a matter of importance. A large number of fillings are possible. We also offer a large variety of additional equipment. If the requirements change over time an easy retrofit during a reconstruction is not a problem with our system.

- ✓ Complete flexibility in installation and construction
- ✓ Filling types can be freely combined
- ✓ Easy installation thanks to FAST CONNECT fittings technology
- ✓ The route of the fence is determined by the shape of the machine
- ✓ Wing doors, sliding doors, lifting and rolling gates
- ✓ No drill holes and threads are necessary in the entire fence
- ✓ The safety fence system meets all requirements of EN ISO 14120:2015



Standard elements or special constructions

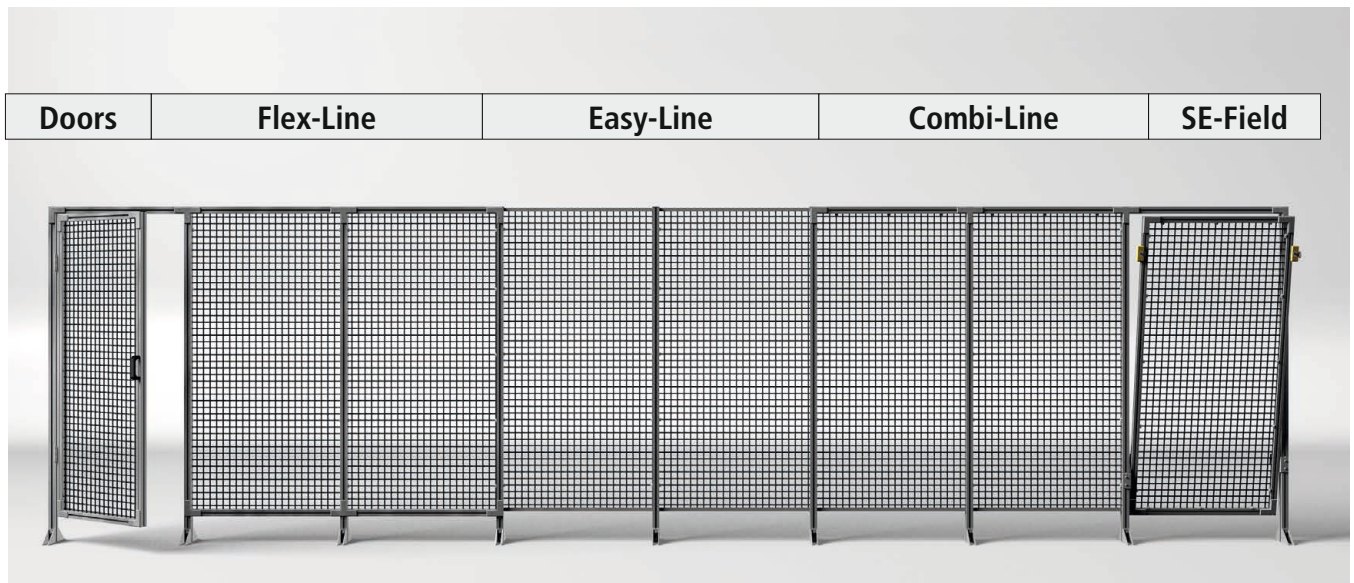

Choose your customized safety fencing system

Design your enclosures your self

You simply order single components. Thanks to our ‚Fast-Connect‘ mounting technique, the protective fence is easily and quickly installed and no drawings needed.

Custom-designed

You provide the drawings or work out a concept with our experienced designers and you will get your tailored quotation.

Assembling service

We install and uninstall your protective fencing world wide. Regardless of whether it is a first start-up or the final assemble at your customer.

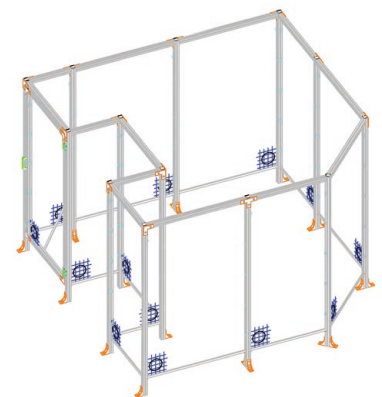

SSP

Safety System Products

SSP Safety System Products GmbH & Co. KG

Zeppelinweg 4 · 78549 Spaichingen

Tel. +49 7424 98049-0 · Fax +49 7424 98049-99

www.safety-products.de · [info@ssp.de.com](mailto:info@ssp.de)

INTERNATIONAL PARTNERS

Find them on our website

www.safety-products.de



we simplify safety